

FOR SUBLEASE

GOLD'S GYM - PENN CROSSING

2117 NW 23RD ST, OKLAHOMA CITY, OK 73107



PROPERTY INFO

+ Highlights

- Located in Penn Crossing's high-traffic retail center
- Space is currently in a finished condition
- Approximately 525 parking spaces available
- Lease Expires: 12/31/2022
- Co-tenants include: Subway, Regional Finance, Studio Nails, Papa John's Pizza, FedEx Office, Citi Trends, Westlake Ace Hardware, Dollar Tree, Vapor Shark, Mazzio's, and China House

AVAILABLE SPACE

- + Space Size
 - ±19,300 SF
- + Lease Rate
 - \$7.00/SF



Traffic Counts

NW 23rd St	16,900 ADT
N Penn Ave	14,900 ADT

Source: Oklahoma Department of Transportation

2019 Demographics

	1 Mile	3 Miles	5 Miles
Population	17,038	99,023	233,230
Households	6,783	43,894	96,512
Average Household Income	\$56,974	\$65,093	\$61,951
Daytime Employment	4,920	8,459	15,962

Retail Science from CBRE

retailtxok.cbre.us

CBRE

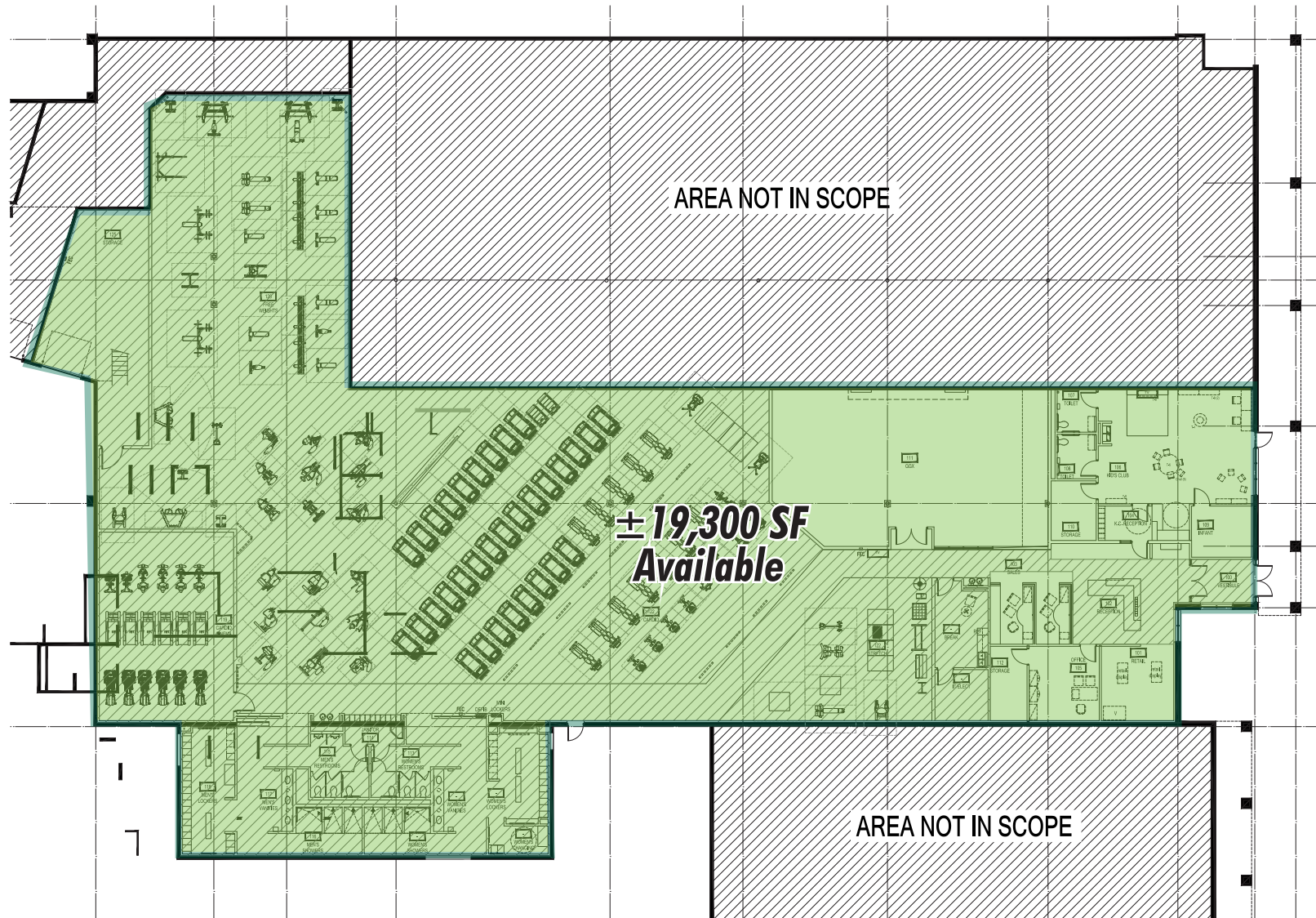



CONTACT US

Mark W. Inman, CPA Stuart Graham

Senior Vice President
405 607 6272
mark.inman@cbre.com

First Vice President
405 607 6027
stuart.graham@cbre.com

Kendra Roberts

Associate
405 607 6050
kendra.roberts@cbre.com

© 2019 CBRE, Inc. All rights reserved. This information has been obtained from sources believed reliable, but has not been verified for accuracy or completeness. You should conduct a careful, independent investigation of the property and verify all information. Any reliance on this information is solely at your own risk. CBRE and the CBRE logo are service marks of CBRE, Inc. All other marks displayed on this document are the property of their respective owners. Photos herein are the property of their respective owners. Use of these images without the express written consent of the owner is prohibited.