

133 GREENE STREET

FLAGSHIP RETAIL OPPORTUNITY BETWEEN PRINCE AND HOUSTON STREET



Premises

GROUND	3,042 SF
MEZZANINE	353 SF
<hr/>	
TOTAL	3,395 SF

CEILING HEIGHTS

GROUND 16' 3"

FRONTAGE 20 ft

POSSESSION Immediate

NOTES

- Beautiful, move-in ready space with rear skylight providing excellent natural light with gorgeous exposed brick archways
- Steps from Apple and Warby Parker's first ever brick and mortar store location
- Formerly occupied by Dior Homme

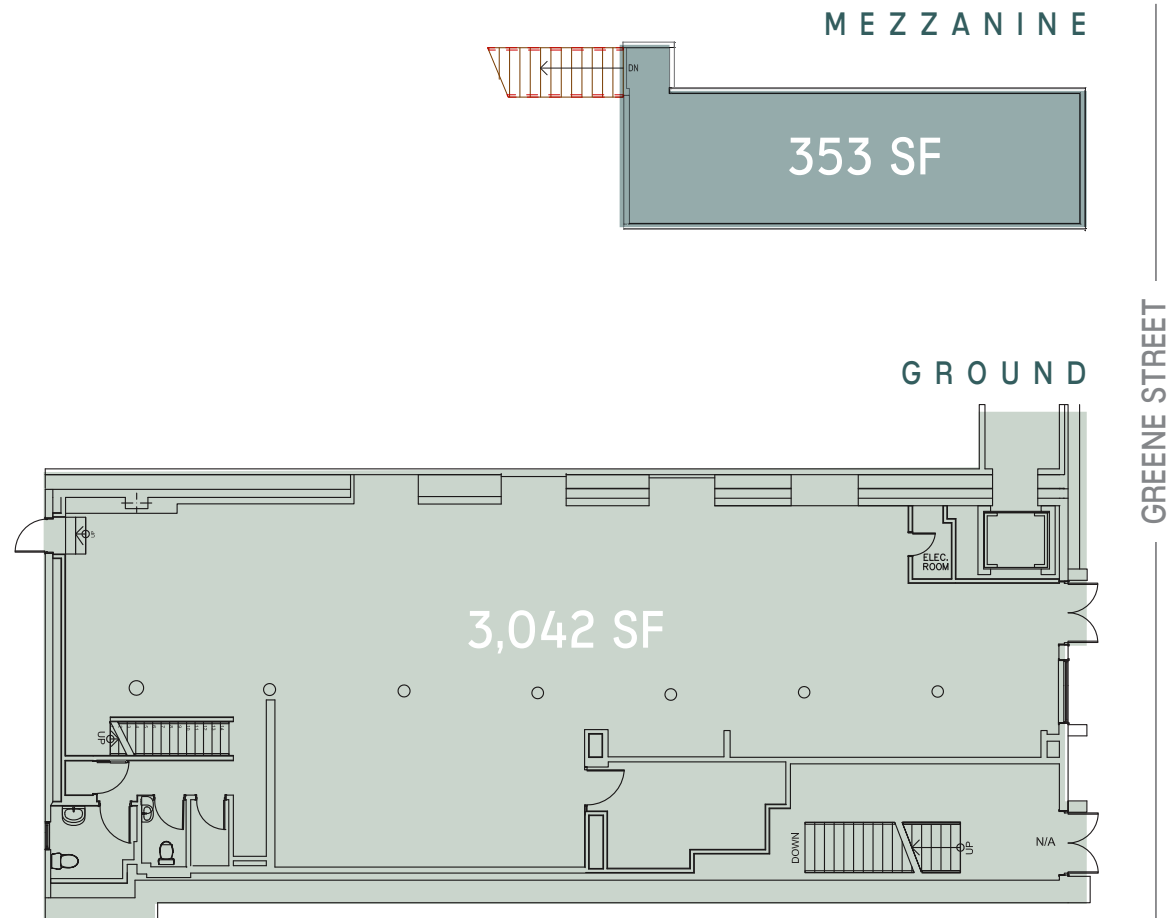

OVER
100,000

SHOPPERS VISIT
SOHO *WEEKLY*

1.5M SF
OF RETAIL SPACE

3M SF
OF OFFICE
SPACE

SOHO IS ONE OF
NEW YORK CITY'S

**Most Desirable
Neighborhoods**

SUBWAY RIDERSHIP
BRINGS

111,183

PEOPLE TO THE
DISTRICT *EVERY DAY*

WEST HOUSTON STREET

VAN LEEUWEN
POMEGRANATE GALLERY

133 GREENE
STREET

WARBY PARKER
Proenza Schouler
RALPH LAUREN

PRINCE STREET

CAMPER

AG

JIMMY CHOO
LINDA FARROW

TASCHEN

Dior

SÖNOS

FENDI

TIFFANY & CO.

HERNO

Chloé

BALENCIAGA

ETRO

GREENE STREET

FLOS

Paul Smith
poggen
pohl

BRUNELLO CUCINELLI

HUGO BOSS



LOUIS VUITTON

STELLA MCCARTNEY

DESIGN
WITHIN
REACH

MCM

Alice + Olivia

REBECCA MINKOFF

DEVIALET

Y-3

BANG & OLUFSEN

SPRING STREET

KENDRA SCOTT

ANINE BING

ELEVENTY

ALEXANDER
MCQUEEN

BURTONS

HERMÈS

Dr. SMOOD

EDEN FINE GALLERY

john varvatos

SAINT LAURENT

VERONICA BEARD

patagonia

TECHNO GYM

INTERIOR DEFINE

WATCHES &
SWITZERLAND
SINCE 1924

ORIGINAL BTC

GOLDEN GOOSE DELUXE

BROOME STREET



133 GREENE
STREET

ERIC GELBER

eric.gelber@cbre.com

212 984 7127

JORDAN KAPLAN

jordan.kaplan@cbre.com

212 984 6576

CASSIE DURAND

cassie.durand@cbre.com

212 984 6528

CHARLOTTE GUNDZIK

charlotte.gundzik@cbre.com

212 984 6520



© 2020 CBRE, Inc. All rights reserved. This information has been obtained from sources believed reliable, but has not been verified for accuracy or completeness. You should conduct a careful, independent investigation of the property and verify all information. Any reliance on this information is solely at your own risk. CBRE and the CBRE logo are service marks of CBRE, Inc. All other marks displayed on this document are the property of their respective owners, and the use of such logos does not imply any affiliation with or endorsement of CBRE.