

1640

N. DAMEN

FLAGSHIP CORNER OPPORTUNITY IN THE  
HEART OF BUCKTOWN

CBRE





# 1640 N. DAMEN

## PROPERTY OVERVIEW

- 1640 N. Damen - located in the heart of Bucktown has available - 3,645 square feet (divisible) on the first floor plus 1,541 SF of lower level space
  - Retail A: 1,804 SF
  - Retail B: 1,841 SF (plus a 1,541 SF lower level)
- Flagship building at the corner of Damen Avenue and Concord Place. Incredible branding opportunity with highly visible signage and a mural opportunity on the southern façade
- 1640 N. Damen is located between the two largest traffic generators in the neighborhood - Damen Blue line (2,155,685 annual riders) and the 606 Trail

## AREA HIGHLIGHTS

- Bucktown is one of Chicago's major shopping destinations with a great mix of national, regional and local retailers including: Aesop, Shinola, Scotch & Soda, lululemon, Blue Mercury, Credo, The North Face, Arc'Teryx, Club Monaco, TOMS and more
- 1640 N. Damen is steps away from one of the busiest intersections in the city - North Avenue/Damen Avenue and Milwaukee Avenue
- The popular Damen retail corridor pulls customers from Bucktown, Wicker Park, Logan Square and Humboldt Park with over 60,000 residents within 5 minutes of the site and 270,000 residents within 10 minutes

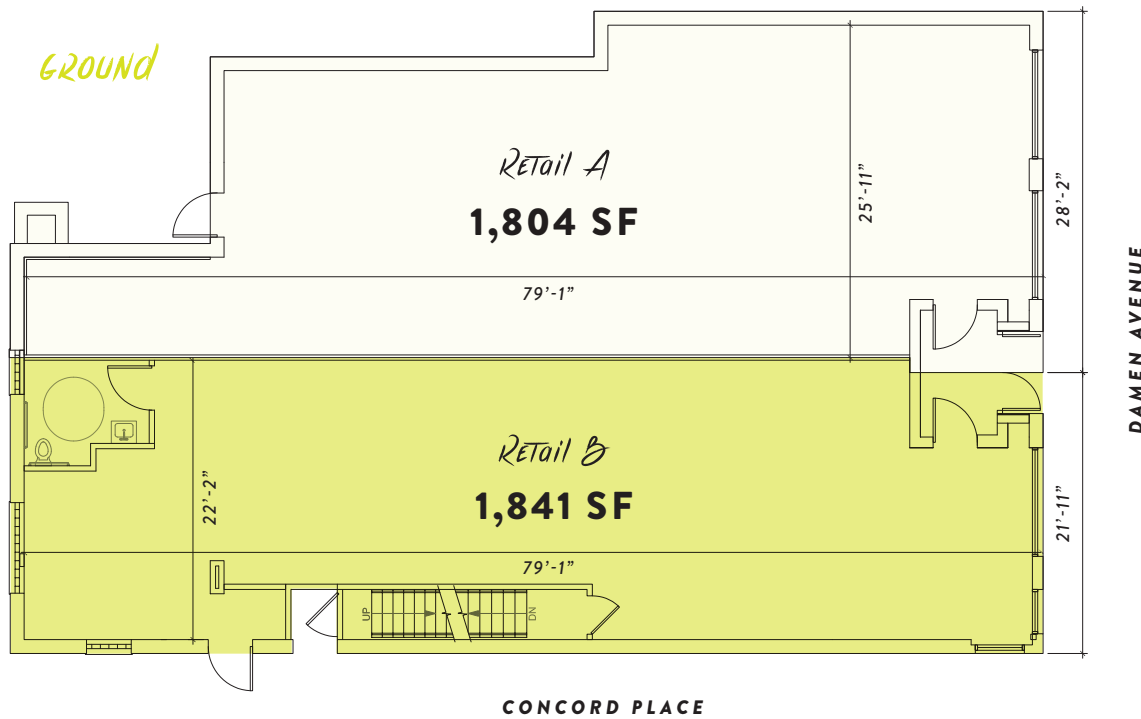

## BASEMENT

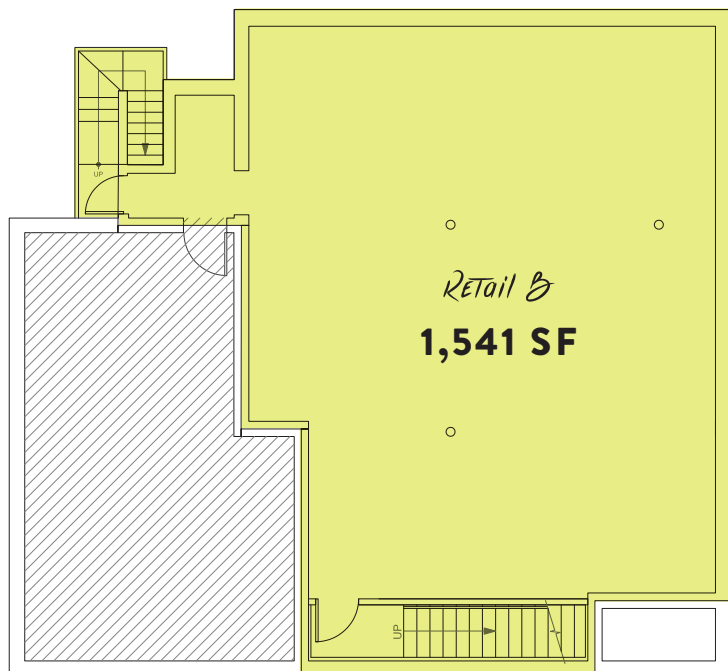



**DAMEN ENTRANCE / EXIT TO 606 TRAIL**  
 80,000 CHICAGOANS LIVE WITH 0.5 MILES OF THE TRAIL



*5+10 MINUTE DRIVE TIME RADIUS*  
 1640 N. DAMEN

**AVERAGE HOUSEHOLD INCOME**

	5 MIN	10 MIN
	<b>\$119,320</b>	<b>\$113,060</b>

**HOUSEHOLDS**

	5 MIN	10 MIN
	<b>28,670</b>	<b>117,564</b>

**POPULATION**

	5 MIN	10 MIN
	<b>60,654</b>	<b>270,464</b>

**DAMEN - BLUELINE CTA STATION**  
 +2.9M RIDERS ANNUALLY

**1640**  
 N. DAMEN

- GALLERY CAFE
- WICKER PARK DENTAL GROUP
- THE DELTA
- DAMEN NORTH DENTAL GROUP
- PIERCE AVE
- LE MOYNE ST

- CHASE
- LAS PALMAS
- LUCIA'S
- PIZZA HUT
- ZEN WINE
- CHOP SHOP
- WICKER TAPSTER PET
- FLASH TACO
- BOCCI
- COLOMBE
- BLUE LINE LOUNGE
- URBANBELLY
- MOON VOYAGE
- GUIDEPOST MONTESSORI SCHOOL
- VIOLET HOUR
- MedSpring urgent care
- Levi's
- 7-ELEVEN
- LIQUOR PARK
- DEBONAIR
- FURIOUS SPIN
- FLAT IRON
- BURTON
- YETI
- REVEL ROOM
- BRU TAXIM
- ART + SCIENCE
- Levi's
- Dove's
- BIGSIAR
- adidas
- UNA MAE'S
- Champion
- carhartt
- NICK'S BEER GARDEN
- LINKS
- JIMMY JOHN'S
- STEVE MADDEN
- WAYWARD PINT
- JOHN FLUEVOG
- GOORIN BROS.
- CHROME
- G-STAR RAW
- URBAN OUTFITTERS
- Schott NYC
- jenis
- NATIVE FOODS
- KIZUKI RAMEN
- UMAMI BURGER
- BUFFALO EXCHANGE
- BONGO ROOM
- MOJO SPA
- SWIG
- EN HAKKORE 2
- TOP DRAWER
- RAGSTOCK
- ARTEMIO'S

- JCYS
- KNEAD
- SULTAN'S CAFE
- 54 11
- ANGRY PIG
- WICKER TAPSTER PET
- FLASH TACO
- BOCCI
- COLOMBE
- BLUE LINE LOUNGE
- URBANBELLY
- MOON VOYAGE
- GUIDEPOST MONTESSORI SCHOOL
- VIOLET HOUR
- MedSpring urgent care
- Levi's
- 7-ELEVEN
- BUCKTOWN FITNESS CLUB
- BUCKTOWN ATHLETIC CLUB
- ELEVATED MINDS
- THE ROBEY CHICAGO
- THE TANKARD
- SUSHI PARA TRIM
- YORK & MINDS
- THE NORTH FACE
- POTBELLY
- TIMBUK2
- SHINOLA DETROIT
- at&t
- DIMO'S PIZZA
- ENSO SUSHI
- TOMS
- COOKING FOOLS
- LOKAL
- PASTA BOWL
- etta
- AKIRA
- FedEx Office



# 1640

# N. DAMEN

*FOR MORE INFORMATION, PLEASE CONTACT:*

**DANNY JACOBSON**  
312.935.1901

DANNY.JACOBSON@CBRE.COM

**LUKE MOLLOY**  
312.935.1905

LUKE.MOLLOY@CBRE.COM

**STEPHEN ANSANI**  
312.935.1907

STEPHEN.ANSANI@CBRE.COM



© 2019 CBRE, INC. ALL RIGHTS RESERVED. THIS INFORMATION HAS BEEN OBTAINED FROM SOURCES BELIEVED RELIABLE, BUT HAS NOT BEEN VERIFIED FOR ACCURACY OR COMPLETENESS. ANY PROJECTIONS, OPINIONS, OR ESTIMATES ARE SUBJECT TO UNCERTAINTY. THE INFORMATION MAY NOT REPRESENT THE CURRENT OR FUTURE PERFORMANCE OF THE PROPERTY. YOU AND YOUR ADVISORS SHOULD CONDUCT A CAREFUL, INDEPENDENT INVESTIGATION OF THE PROPERTY AND VERIFY ALL INFORMATION. ANY RELIANCE ON THIS INFORMATION IS SOLELY AT YOUR OWN RISK. CBRE AND THE CBRE LOGO ARE SERVICE MARKS OF CBRE, INC. AND/OR ITS AFFILIATED OR RELATED COMPANIES IN THE UNITED STATES AND OTHER COUNTRIES. ALL OTHER MARKS DISPLAYED ON THIS DOCUMENT ARE THE PROPERTY OF THEIR RESPECTIVE OWNERS. PHOTOS HEREIN ARE THE PROPERTY OF THEIR RESPECTIVE OWNERS AND USE OF THESE IMAGES WITHOUT THE EXPRESS WRITTEN CONSENT OF THE OWNER IS PROHIBITED.

# CBRE