

FOR SALE OR LEASE

Harmar Township

5 ALPHA DRIVE | PITTSBURGH, PA 15238

BACK ON THE MARKET

RETAIL

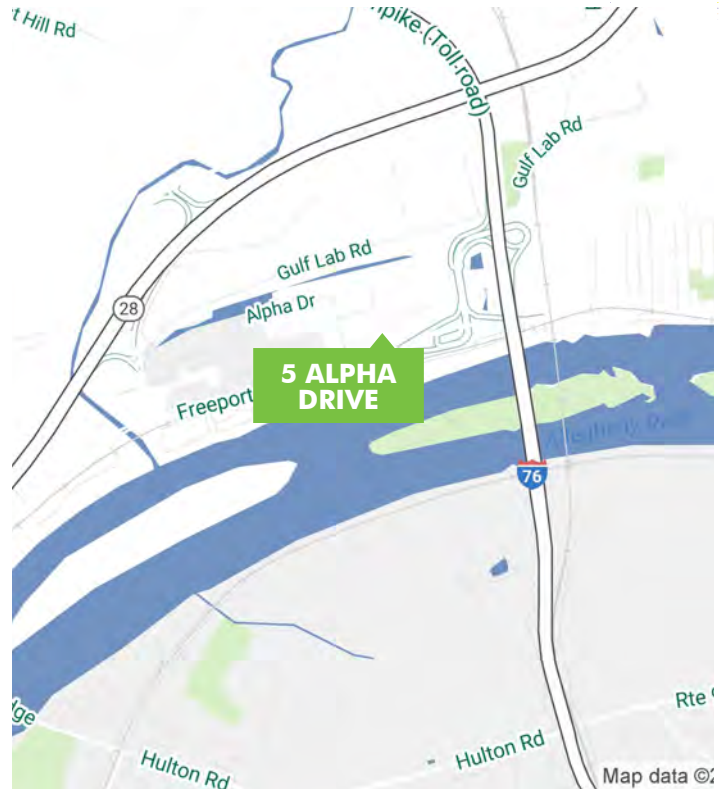

PROPERTY INFO

- + 8,159 square foot building on 1.19 acres with 97 parking spaces.
- + Close proximity to Route 28, Route 910 and Exit 48 of the PA Turnpike
- + 23,043 ADT on Freeport Road and 41,600 ADT on PA Turnpike
- + Zoned: C-2 Commercial
- + Nearby businesses include Target, Sheetz, McDonald's, KFC, Burger King, Hampton Inn & Suites, Towne Place Suites, Days Inn, Holiday Inn Express, RIDC Park and U-PARC
- + Easy access to traffic signal at Freeport Road and Alpha Drive
- + Parcel #442-A-136

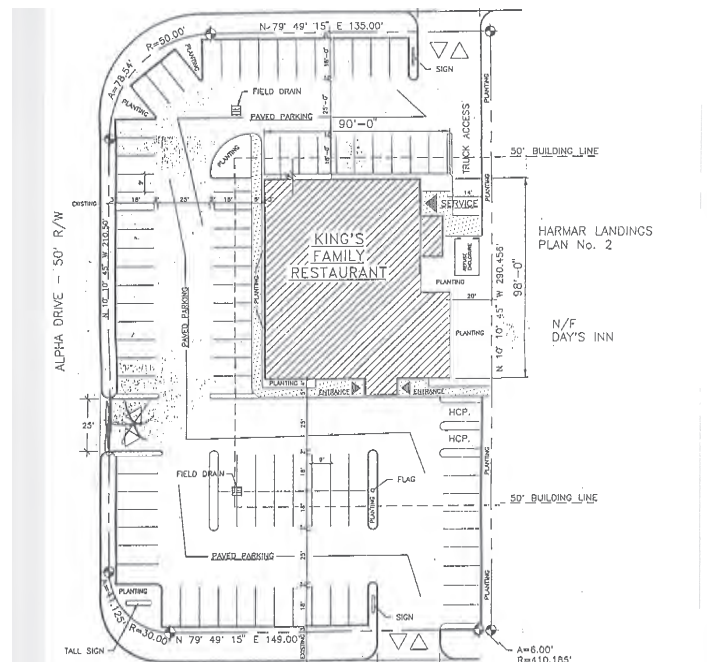

FOR SALE OR LEASE

Harmar Township

5 ALPHA DRIVE | PITTSBURGH, PA 15238

RETAIL



2019 Estimated Demographics

	One mile	Three miles	Five miles		One mile	Three miles	Five miles
Population	1,556	30,669	85,561	Average Household Income	\$75,702	\$92,116	\$89,525
Households	571	13,870	37,966	Daytime Population	4,051	33,454	89,272

CONTACT US

Steven Esposito

First Vice President
+1 412 394 9845
steve.esposito@cbre.com

Miles Smith

First Vice President
+1 412 394 9843
miles.smith@cbre.com

© 2020 CBRE, Inc. This information has been obtained from sources believed reliable. We have not verified it and make no guarantee, warranty or representation about it. Any projections, opinions, assumptions or estimates used are for example only and do not represent the current or future performance of the property. You and your advisors should conduct a careful, independent investigation of the property to determine to your satisfaction the suitability of the property for your needs. Photos herein are the property of their respective owners and use of these images without the express written consent of the owner is prohibited. CBRE and the CBRE logo are service marks of CBRE, Inc. and/or its affiliated or related companies in the United States and other countries. All other marks displayed on this document are the property of their respective owners.

www.cbre.us/pittsburgh

CBRE