

CBRE

UNION
STATION

RETAIL

THE SITE

75,000

DAILY VISITORS

22 MILLION

VISITORS ANNUALLY

880

ARRIVAL/DEPARTURES DAILY
(LIGHT AND HEAVY RAIL)

EAST PORTAL VENUES

± 60 - 700 SF

TICKETING CONCOURSE

± 11,985 SF

POTENTIAL ±3,000 SF RESTAURANT AND
FEATURED BAR SHOWCASE SPACE

OVER \$2 BILLION

IN EXPANSIONS AND UPGRADES
IN PROGRESS

OVER 5 NEW CONCEPTS

RANGING FROM HIGH-PROFILE
RESTAURANTS TO NICHE CAFE

EAST PORTAL - TRANSIT LEVEL

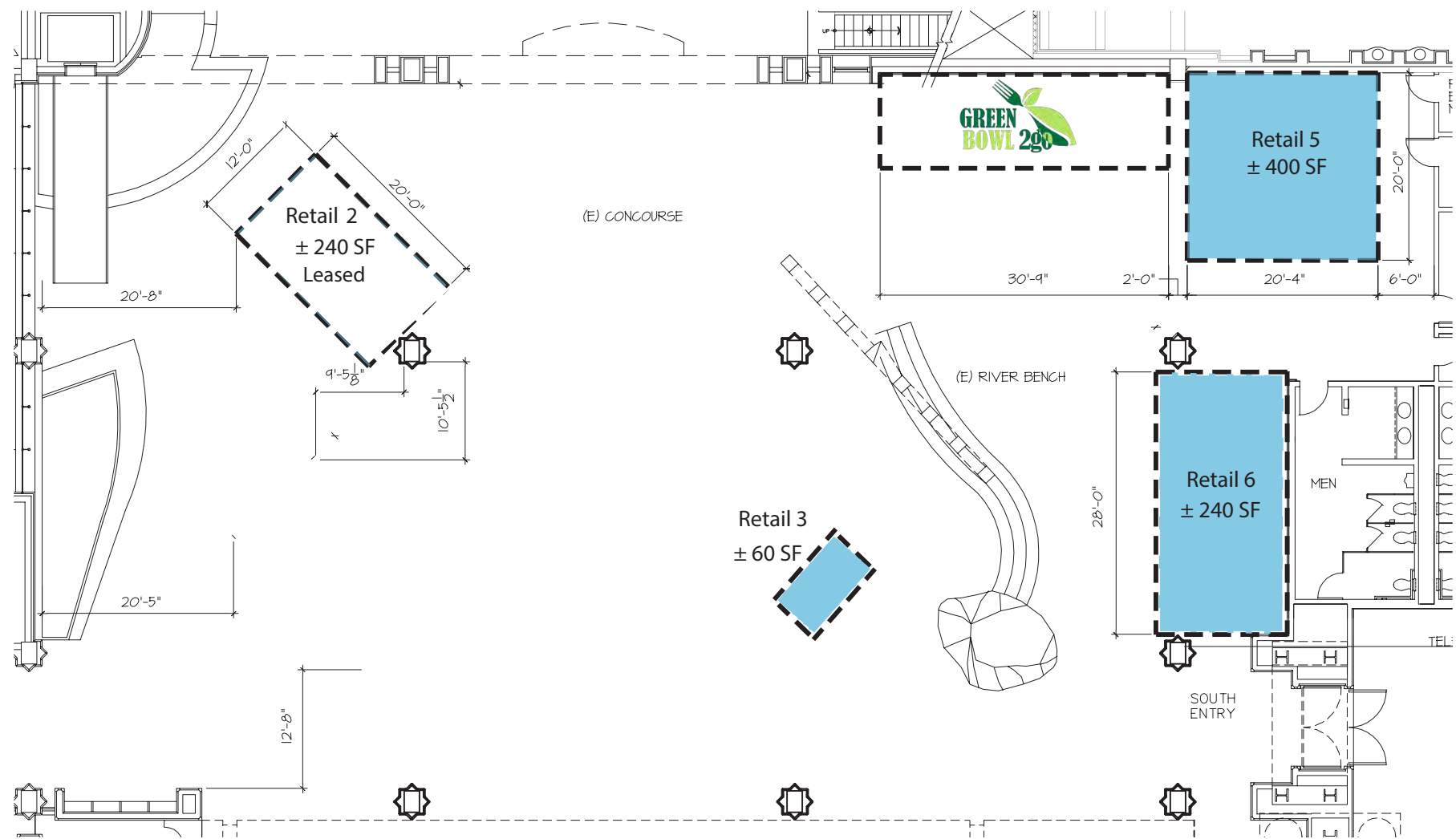

THE EAST PORTAL

Patsaouras Plaza Level

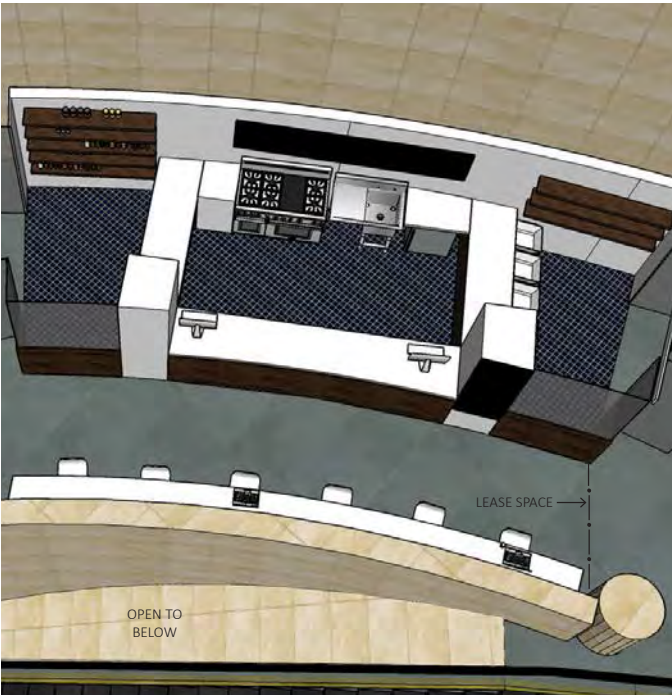
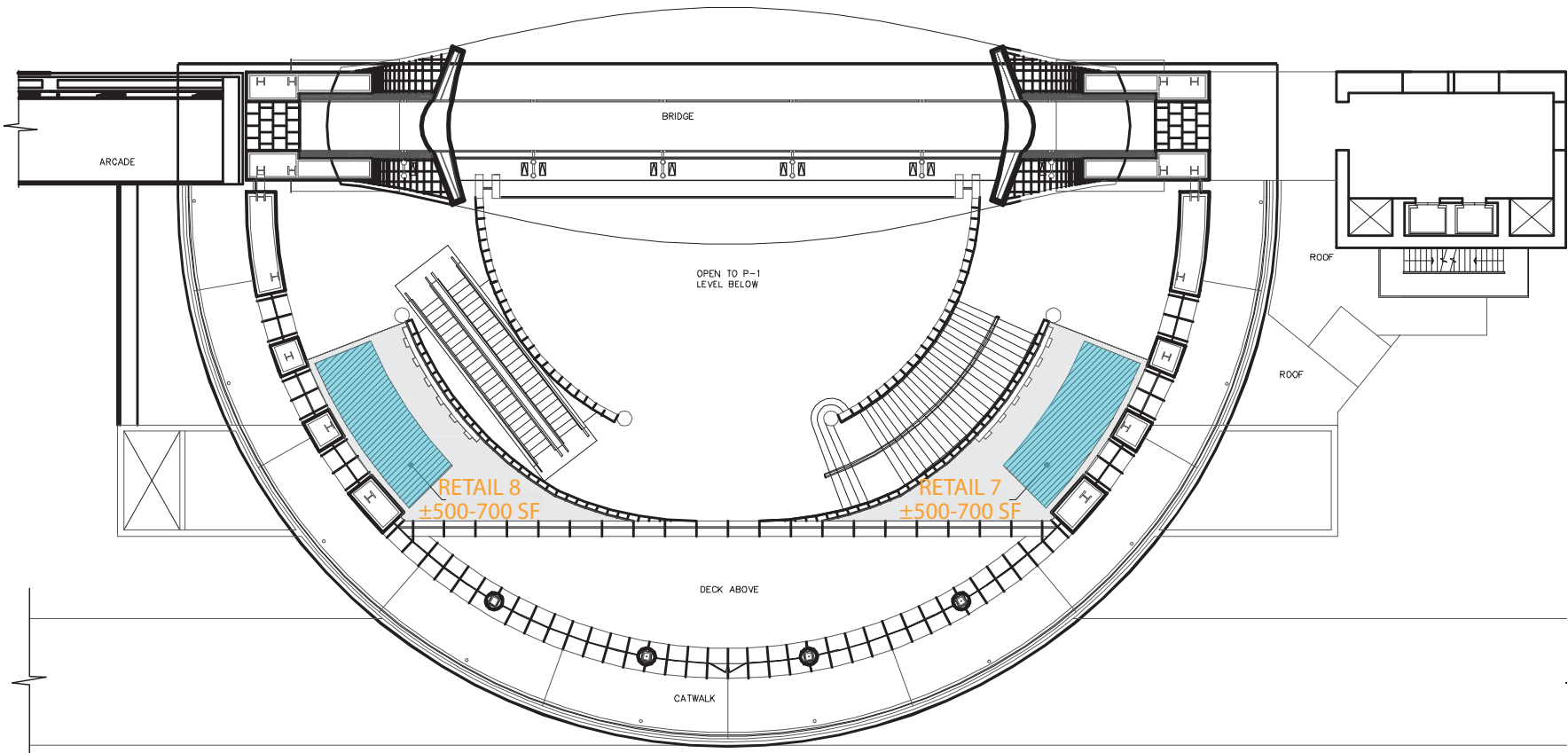

Conceptual Design (Not Existing)

TICKETING & PASSENGER CONCOURSES

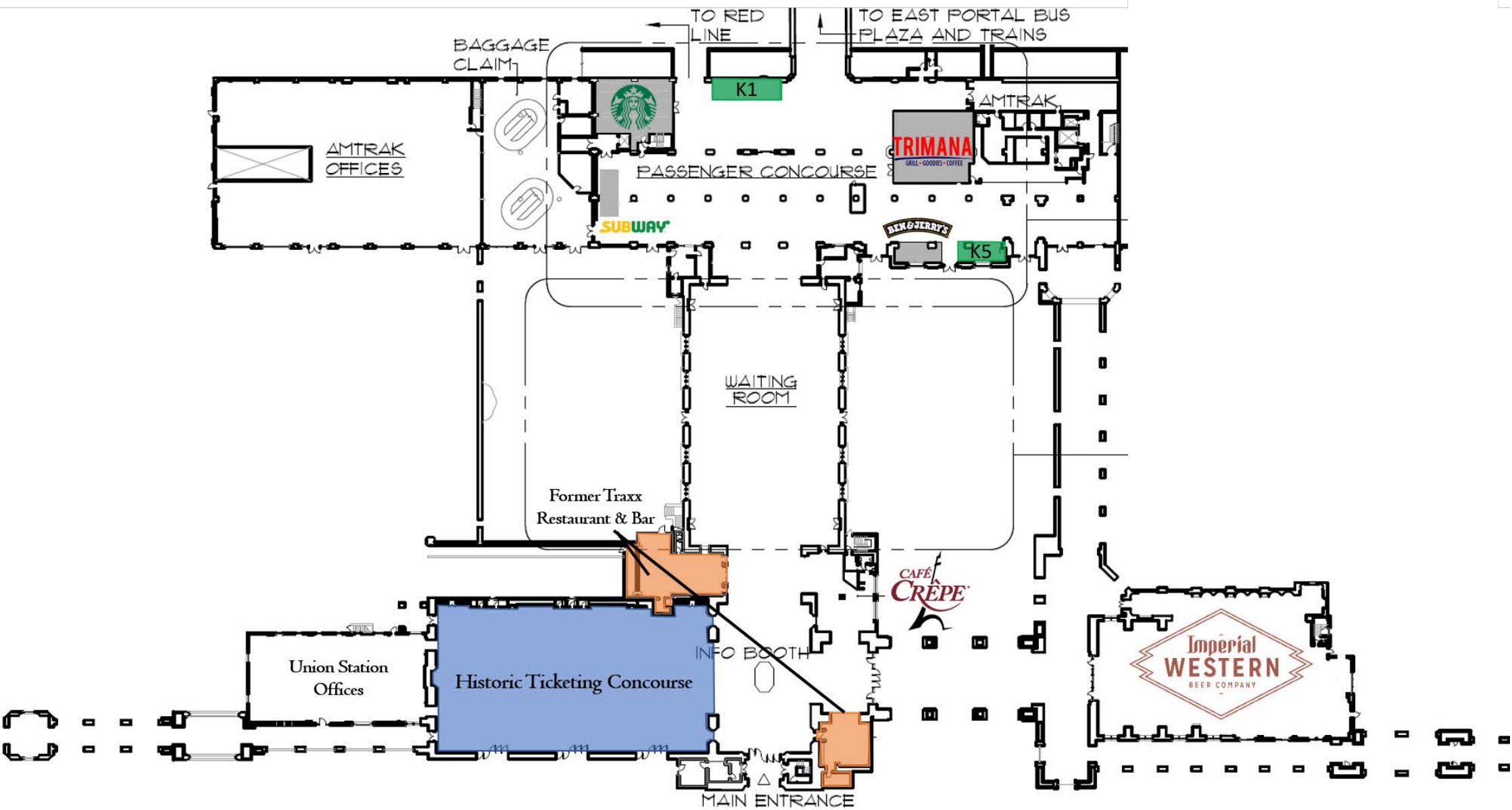

FORMER TRAXX RESTAURANT & BAR

*CAN BE LEASED SEPARATELY

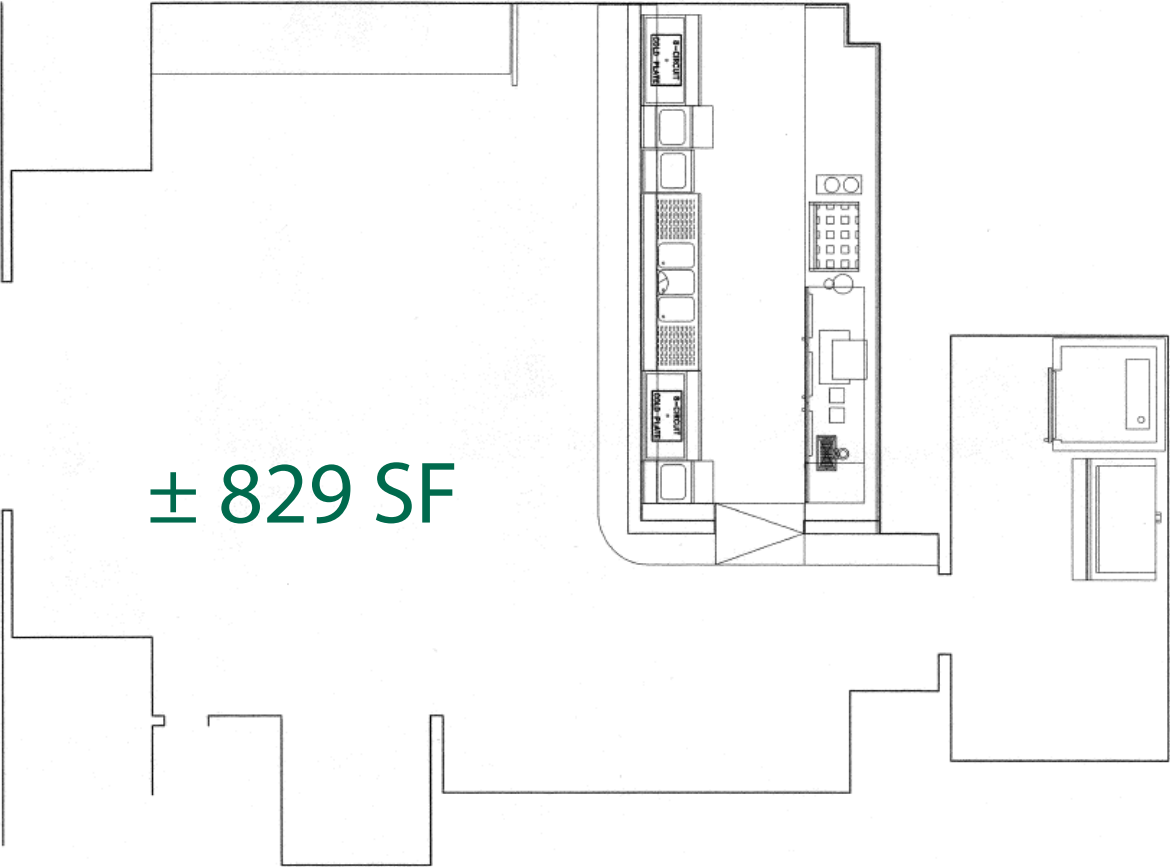

± 829 SF

BAR PLAN

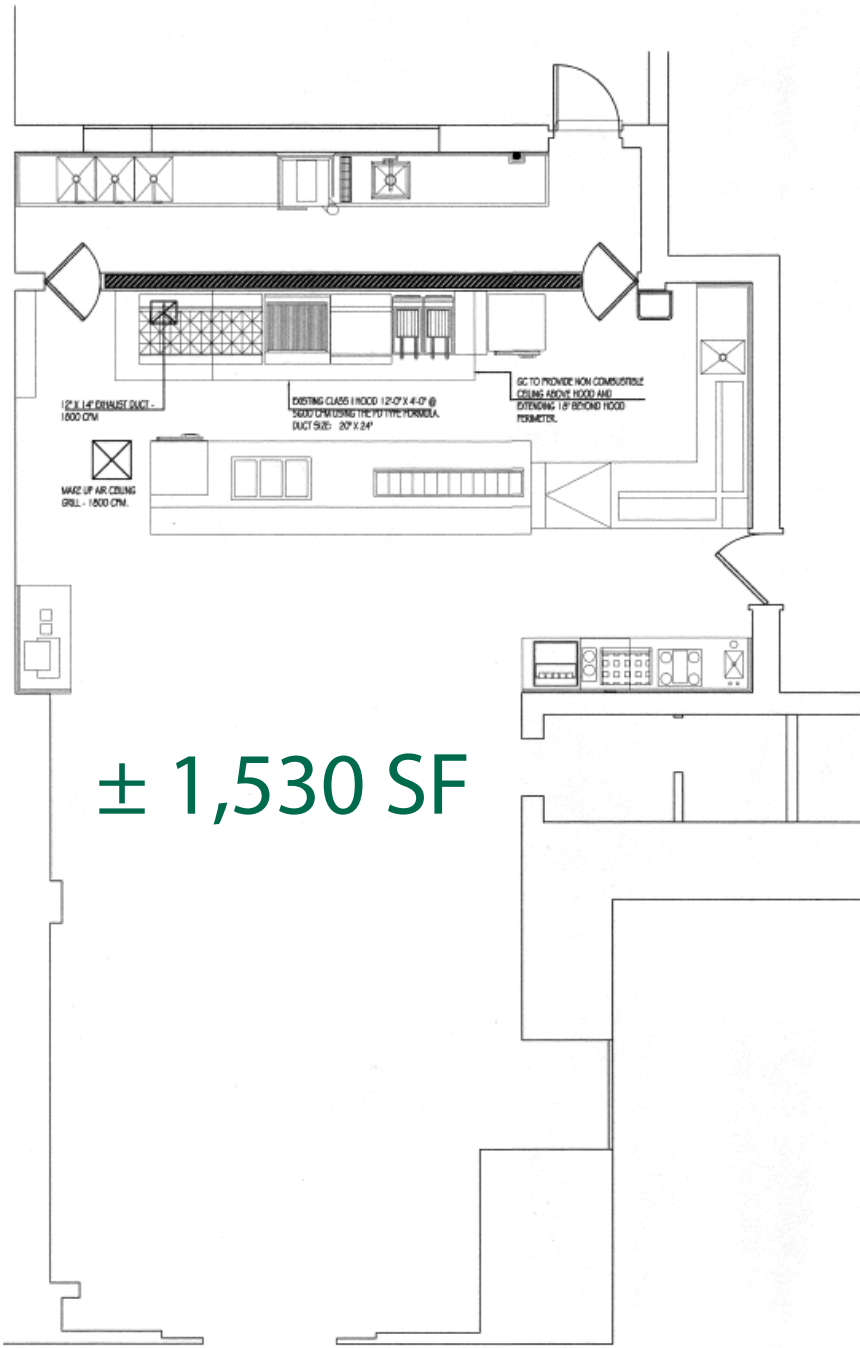

± 1,530 SF

RESTAURANT EQUIPMENT FLOOR PLAN.

PASSENGER CONCOURSE

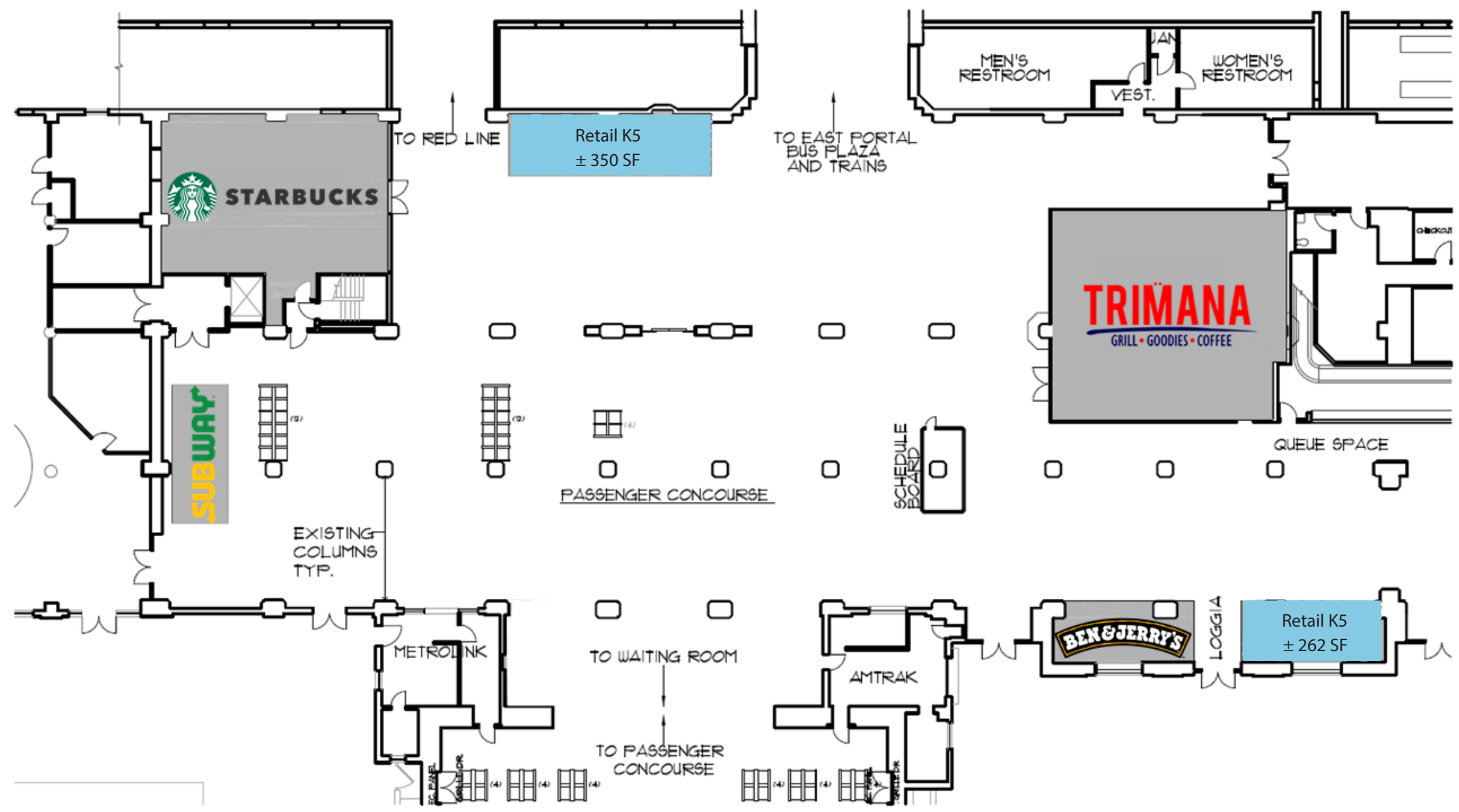

THE METRO



22 MILLION
ANNUAL RIDERS

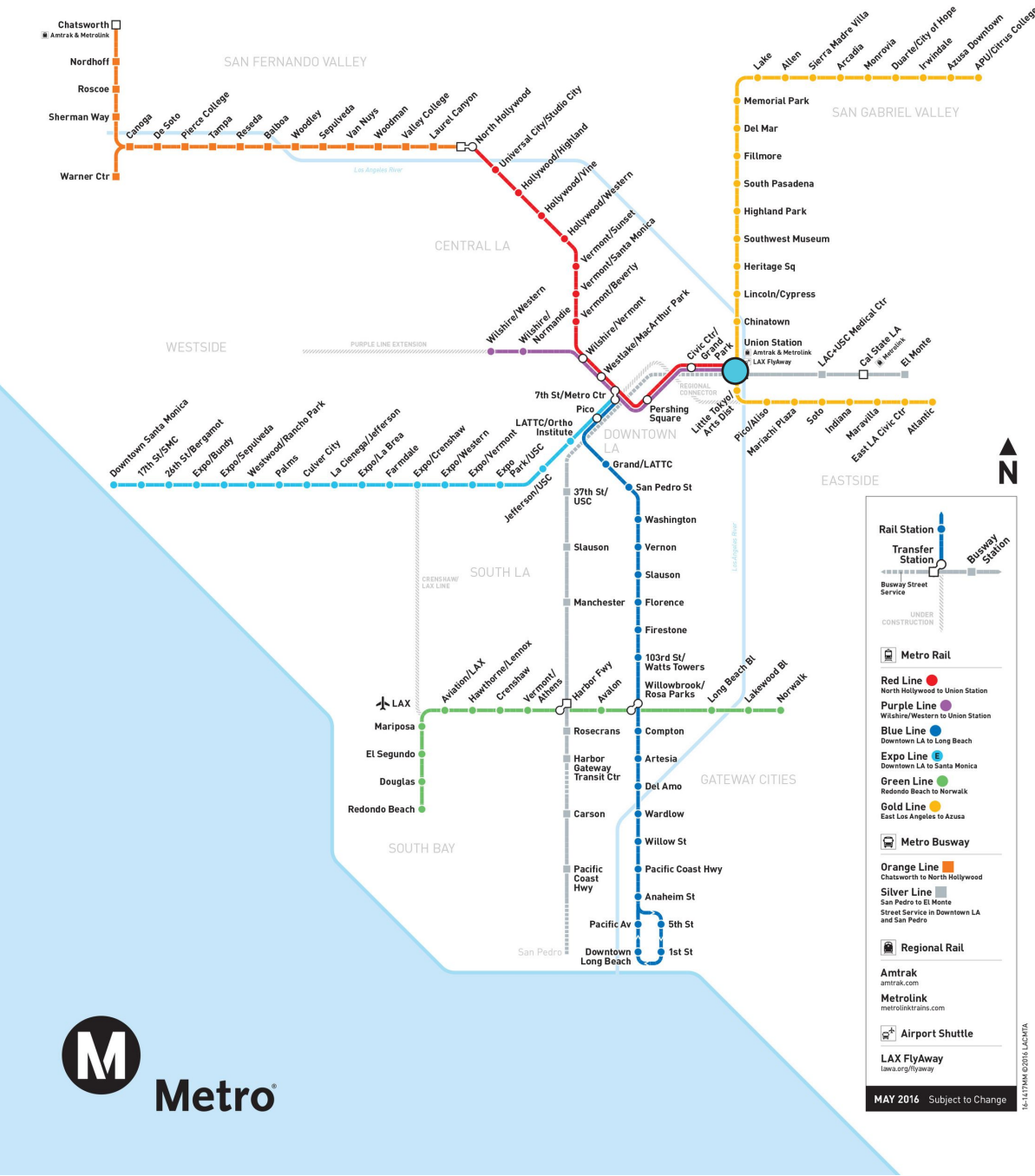



FOR MORE INFORMATION, CONTACT DERRICK MOORE:

Derrick Moore

Senior Vice President

213.613.3272

derrick.moore@cbre.com

CA License #01029938

Matt Aguilar

Client Services Specialist

213.613.3219

matt.aguilar@cbre.com

CA License #02112401

© 2019 CBRE, Inc. All rights reserved. This information has been obtained from sources believed reliable, but has not been verified for accuracy or completeness. You should conduct a careful, independent investigation of the property and verify all information. Any reliance on this information is solely at your own risk. CBRE and the CBRE logo are service marks of CBRE, Inc. All other marks displayed on this document are the property of their respective owners, and the use of such logos does not imply any affiliation with or endorsement of CBRE. Photos herein are the property of their respective owners. Use of these images without the express written consent of the owner is prohibited.